

PARCELAS ESTUDIO DE DETALLE VIGENTE

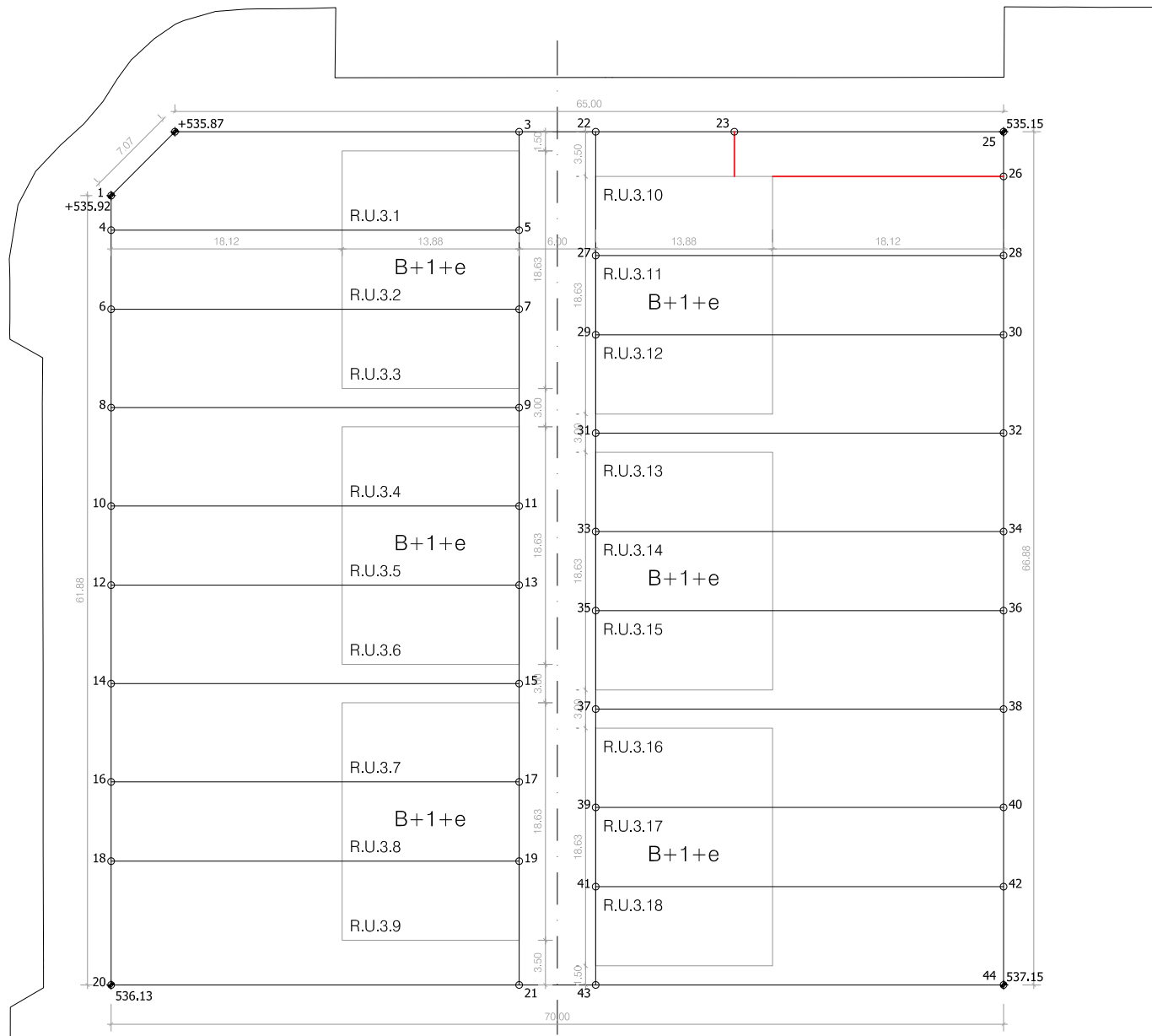

| ESTUDIO DE DETALLE | |
|--------------------|--------------|
| PARCELA | SUPERF. (m2) |
| R.U.3 | 4.669,21 |
| R.U.3.1 | 234,19 |
| R.U.3.2 | 198,69 |
| R.U.3.3 | 246,69 |
| R.U.3.4 | 246,69 |
| R.U.3.5 | 198,69 |
| R.U.3.6 | 246,69 |
| R.U.3.7 | 246,69 |
| R.U.3.8 | 198,69 |
| R.U.3.9 | 310,69 |
| R.U.3.10 | 237,50 |
| R.U.3.11 | 198,69 |
| R.U.3.12 | 246,69 |
| R.U.3.13 | 246,69 |
| R.U.3.14 | 198,69 |
| R.U.3.15 | 246,69 |
| R.U.3.16 | 246,69 |
| R.U.3.17 | 198,69 |
| R.U.3.18 | 246,69 |
| R.U.3.Común | 474,48 |

| PUNTO | (X) | (Y) | PUNTO | (X) | (Y) | PUNTO | (X) | (Y) |
|-------|--------------|----------------|-------|--------------|----------------|-------|--------------|----------------|
| 1 | 524.042,5289 | 4.743.280,8349 | 16 | 524.059,9978 | 4.743.238,3206 | 31 | 524.084,7569 | 4.743.278,0479 |
| 2 | 524.045,2533 | 4.743.287,3599 | 17 | 524.089,5965 | 4.743.250,4826 | 32 | 524.114,3556 | 4.743.290,2099 |
| 3 | 524.070,2273 | 4.743.297,6217 | 18 | 524.062,3576 | 4.733.232,5775 | 33 | 524.087,6868 | 4.743.270,9173 |
| 4 | 524.043,5585 | 4.743.278,3291 | 19 | 524.091,9563 | 4.743.244,7395 | 34 | 524.117,2855 | 4.743.283,0793 |
| 5 | 524.073,1572 | 4.743.290,4911 | 20 | 524.066,0476 | 4.743.223,5970 | 35 | 524.090,0466 | 4.743.265,1742 |
| 6 | 524.045,9183 | 4.743.272,5860 | 21 | 524.095,6464 | 4.743.235,7590 | 36 | 524.119,6453 | 4.743.277,3362 |
| 7 | 524.075,5170 | 4.743.284,7480 | 22 | 524.075,7771 | 4.743.299,9020 | 37 | 524.092,9765 | 4.743.258,0437 |
| 8 | 524.048,8482 | 4.743.265,4554 | 23 | 524.086,0336 | 4.743.304,1164 | 38 | 524.122,5753 | 4.743.270,2057 |
| 9 | 524.078,4469 | 4.743.277,6174 | 24 | 524.087,3638 | 4.743.300,8790 | 39 | 524.095,9065 | 4.743.250,9130 |
| 10 | 524.051,7782 | 4.743.258,3248 | 25 | 524.105,3759 | 4.743.312,0641 | 40 | 524.125,5052 | 4.743.263,0751 |
| 11 | 524.081,3769 | 4.743.270,4868 | 26 | 524.106,7061 | 4.743.308,8267 | 41 | 524.098,2663 | 4.743.245,1700 |
| 12 | 524.054,1380 | 4.743.252,5817 | 27 | 524.079,4672 | 4.743.290,9216 | 42 | 524.127,8650 | 4.743.257,3320 |
| 13 | 524.083,7367 | 4.743.264,7437 | 28 | 524.109,0659 | 4.743.303,0836 | 43 | 524.101,1962 | 4.743.238,0395 |
| 14 | 524.057,0679 | 4.743.245,4512 | 29 | 524.081,8270 | 4.743.285,1785 | 44 | 524.130,7949 | 4.743.250,2015 |
| 15 | 524.086,6666 | 4.743.257,6132 | 30 | 524.111,4257 | 4.743.297,3405 | | | |

PARCELAS 1ª MODIFICACIÓN DEL ESTUDIO DE DETALLE

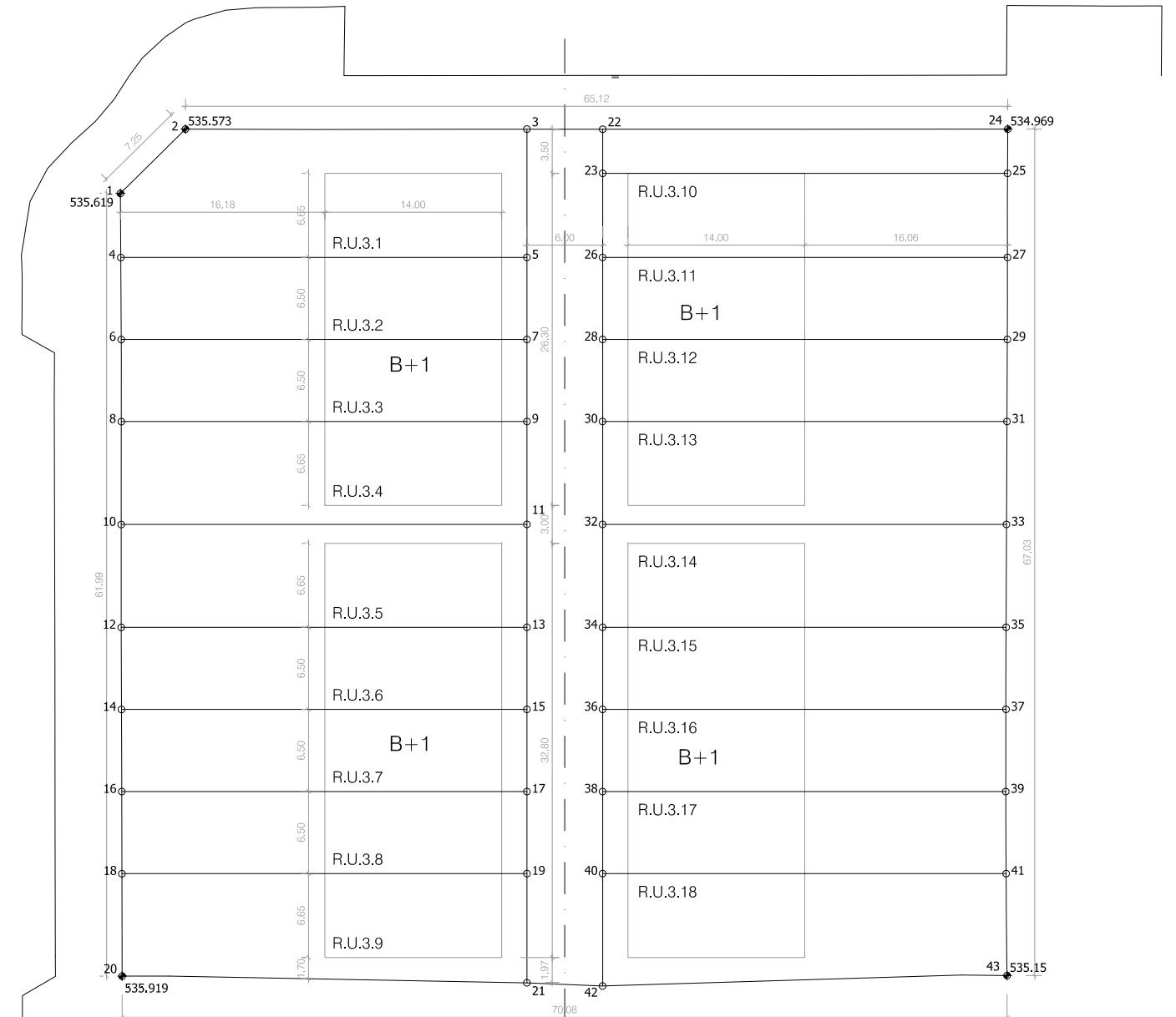

| 1ª MODIFICACIÓN E. D. | |
|-----------------------|--------------|
| PARCELA | SUPERF. (m2) |
| R.U.3 | 4.710,35 |
| R.U.3.1 | 313,34 |
| R.U.3.2 | 208,95 |
| R.U.3.3 | 208,79 |
| R.U.3.4 | 261,84 |
| R.U.3.5 | 261,86 |
| R.U.3.6 | 208,77 |
| R.U.3.7 | 208,61 |
| R.U.3.8 | 208,50 |
| R.U.3.9 | 267,83 |
| R.U.3.10 | 213,17 |
| R.U.3.11 | 208,43 |
| R.U.3.12 | 208,23 |
| R.U.3.13 | 260,76 |
| R.U.3.14 | 260,50 |
| R.U.3.15 | 207,66 |
| R.U.3.16 | 207,57 |
| R.U.3.17 | 207,56 |
| R.U.3.18 | 269,32 |
| R.U.3.Común | 518,66 |

| PUNTO | (X) | (Y) | PUNTO | (X) | (Y) | PUNTO | (X) | (Y) |
|-------|------------|----------------|-------|------------|----------------|-------|------------|----------------|
| 1 | 523.935,96 | 4.743.072,9510 | 16 | 523.954,02 | 4.743.029,1617 | 31 | 524.007,78 | 4.743.082,8475 |
| 2 | 523.938,81 | 4.743.079,6150 | 17 | 523.983,71 | 4.743.041,3235 | 32 | 523.981,24 | 4.743.063,1694 |
| 3 | 523.963,83 | 4.743.089,8563 | 18 | 523.956,50 | 4.743.023,1515 | 33 | 524.010,83 | 4.743.075,2897 |
| 4 | 523.937,91 | 4.743.068,2736 | 19 | 523.986,17 | 4.743.035,3085 | 34 | 523.984,33 | 4.743.055,6277 |
| 5 | 523.967,67 | 4.743.080,4667 | 20 | 523.959,59 | 4.743.015,6410 | 35 | 524.013,90 | 4.743.067,7403 |
| 6 | 523.940,41 | 4.743.062,2734 | 21 | 523.989,45 | 4.743.027,3007 | 36 | 523.986,80 | 474.304,6127 |
| 7 | 523.970,14 | 4.743.074,4518 | 22 | 523.969,38 | 4.743.092,1353 | 37 | 524.016,36 | 4.743.061,7204 |
| 8 | 523.942,88 | 4.743.056,2598 | 23 | 523.970,71 | 4.743.088,8948 | 38 | 523.989,26 | 4.743.043,5978 |
| 9 | 523.972,60 | 4.743.068,4368 | 24 | 523.999,07 | 4.743.104,2990 | 39 | 524.018,80 | 4.743.055,6997 |
| 10 | 523.945,96 | 4.743.048,7161 | 25 | 524.000,38 | 4.743.101,0484 | 40 | 523.991,73 | 443.037,5829 |
| 11 | 523.975,69 | 4.743.060,8951 | 26 | 523.973,23 | 4.743.082,7410 | 41 | 524.021,29 | 4.743.049,6953 |
| 12 | 523.949,05 | 4.743.041,1735 | 27 | 524.002,90 | 4.743.094,8951 | 42 | 523.995,10 | 4.743.029,3482 |
| 13 | 523.979,10 | 4.743.053,4262 | 28 | 523.975,69 | 4.743.076,7261 | 43 | 524.024,43 | 4.743.042,2490 |
| 14 | 523.951,54 | 4.743.035,1682 | 29 | 524.005,35 | 4.743.088,8762 | | | |
| 15 | 523.981,25 | 4.743.047,3384 | 30 | 523.978,15 | 4.743.070,7112 | | | |

La superficie total de parcela de la 1ª Modificación del Estudio de Detalle es la comprobada mediante levantamiento topográfico de dicha parcela.

MARIANO FLORES ARQUITECTO
94 433 7360 | www.mfaarq.es
mariano@mfaarq.es

1ª MODIFICACIÓN ESTUDIO DE DETALLE
MANZANA RU-03 MOA-2/28. S. 6. MARITURRI. VITORIA-GASTEIZ
plano PLANO DE INFORMACIÓN PARCELAS
promotor ABAIGAR PROMOCIÓN Y CONSTRUCCIÓN S.L.
1/500
Estudio Detalle
Nov 2019

03 | 103
FLORES
TALLER DE ARQUITECTURA